

HOZELOCK

2802

15 Pot Watering Kit



1

Year guarantee
Ans de garantie
Jahre garantie
Jaar garantie
Años de garantía
Χρόνια εγγύηση



Hozelock Ltd.
Midpoint Park, Birmingham,
B76 1AB, England
Tel: +44 (0) 121 313 1122

www.hozelock.com

43147-000

Contents

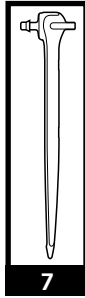
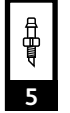
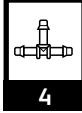
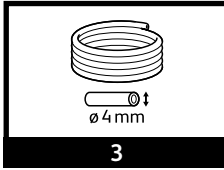
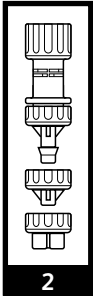
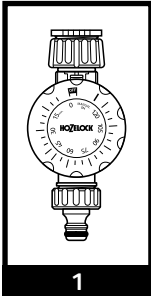

- 1** Mechanical Timer (x1)
- 2** Pressure Reducer (x1)
- 3** 10m (ø4mm) Micro Tube
- 4** T-Connector (x14)
- 5** Straight Connector (x5)
- 6** Wall Clip (x5)
- 7** Dripper with Stake (x15)

* Component aesthetics may vary.

Example layout

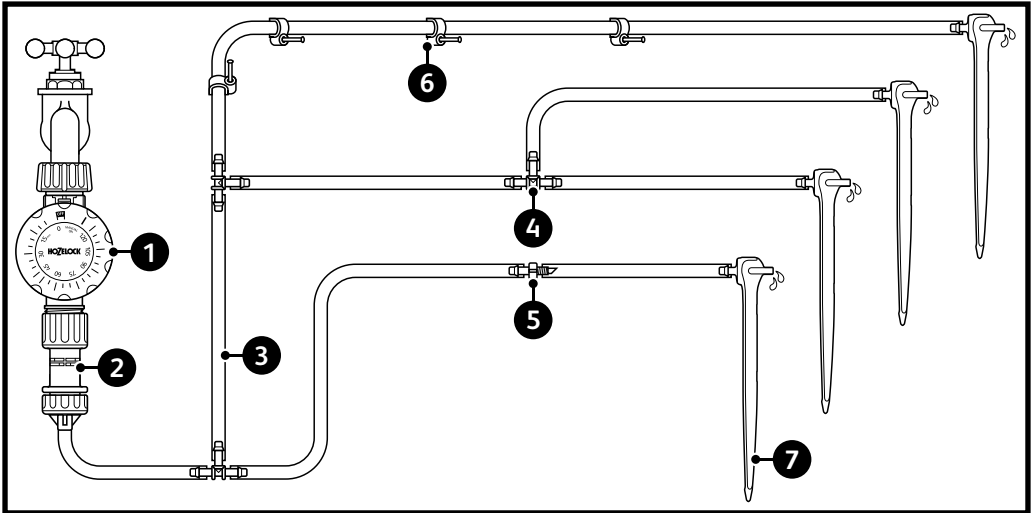

Installing the system

A - Control

1 Mechanical Timer

Automatically control how you water your garden, saving you time, water and effort. The mechanical count down timer attaches to the outside tap and turns the water off after a required duration.

The system can be connected to the tap using the following methods:

- i** If the timer is used then screw the pressure regulator to the timer and screw the timer to the outside tap. The white arrows on the sides of the timer indicate the water flow direction away from the tap.

DO NOT ATTEMPT TO CONNECT THE TIMER WITH THE ARROWS POINTING TOWARDS THE TAP AS THIS MAY DAMAGE THE TIMER.

- ii** If the timer is not used the pressure regulator can be screwed directly onto the outside tap.
- The timer can be turned to the 'MANUAL ON' setting for continuous un-timed watering.
- To set a water time duration turn the main dial clockwise to the desired duration.
- The timer can be turned to the 'OFF' setting at any time during a count down cycle, or from the 'manual on' setting.

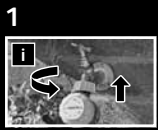

2 Pressure Reducer

Reduces water pressure delivered from the mains tap to your system, to ensure optimal performance. An integrated filter prevents dirty water affecting dripper performance.

Connect the Pressure Regulator to the Micro Tube by using the appropriate 4mm adaptor and push the Micro Tube through the centre.

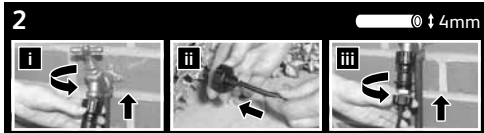

C - Drippers

Drippers can be fitted onto the end of the Micro Tube.

7 Dripper with Stake

With its compact design and integrated spike, the dripper is easily secured into place and discreetly delivers water to your pots and borders at a rate of 4 litres per hour.

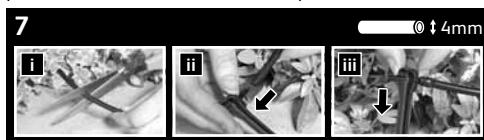

B - Pipeline

3 Micro Tube

A small flexible 4mm tube used to transport water around small systems. This can be cut and adapted to create your ideal watering system layout. It efficiently carries water from the main supply and delivers it to your plants via a network of drippers. Adjust your system using Straight Connectors (5) or split the flow using T-Connectors (4). Secure in place using Wall Clips (6).

Note: No one length of Micro Tube should be more than 15m long.

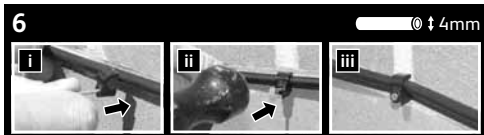
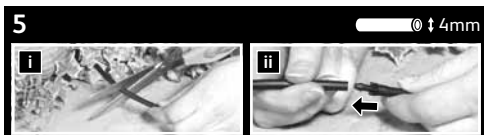

4 T-Connectors

Enable you to customise the water flow around your garden by allowing you to alter and extend the layout of your watering system.



Occasional slight leakage can occur from the connection point. This usually seals over time, but ensure the fitting is correctly inserted at a 90° angle.

Calculating the capacity of the system

If fitting a large system, calculate the flow from the supply, and therefore how many accessories the flow will support:

- Using a pressure regulator with the tap fully on, time in seconds how long it will take to fill a bucket of known volume in litres.
- Multiply the number of litres in your bucket by 3600, and divide by the number of seconds it took to fill. This will give you your maximum flow rate of litres per hour.
- Each dripper has a given flow rate, the total water requirement of all the drippers that you use added together should not exceed the maximum flow rate.

E.g.:

- A 9 litre bucket is filled in 15 seconds
- 9 litres x 3600 = 42400
- 42400/15 seconds = 2160

If more drippers are required than the maximum flow permits, separate the system into sections that can be run at different times. If you wish to automate this you will need more than one water computer.

Maintenance

At the end of the season, open all flow control valves and remove end sleeves. Flush with water to clean, and then drain to avoid frost damage. Remove the pressure regulator and water computer and store away from frost. All drippers may be dismantled for cleaning. Soak in an equal mixture of vinegar and water to remove any residues.

Contact

For product advice please contact:

Hozelock Consumer Services,
Hozelock Ltd., Midpoint Park, Birmingham, B76 1AB.

Tel: 0121 313 1122

www.hozelock.com

